

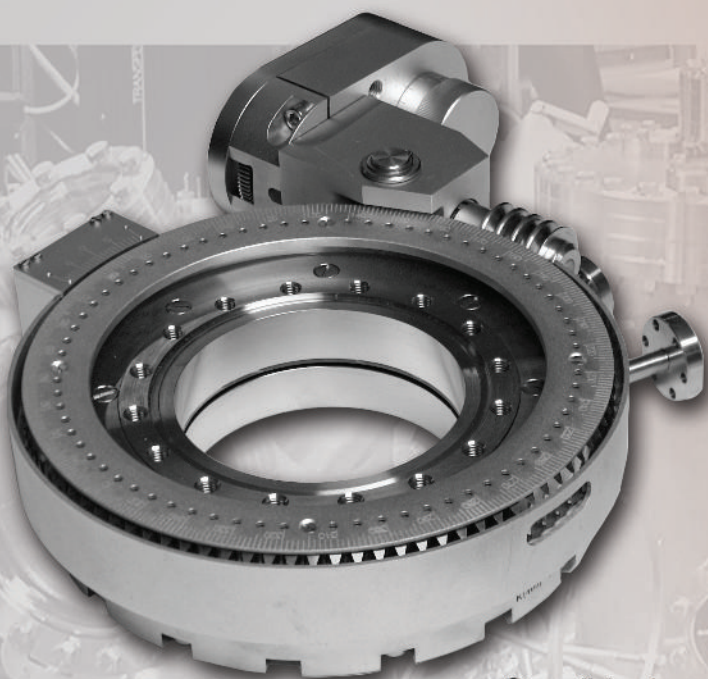

OmniVac

Surface Analysis and Vacuum Technology

Differentially pumped rotary Feedthrough CF100/63 DPRF 100/63



OmniVac's differentially pumped rotary feedthroughs provide full 360° continuous rotation at a base pressure of $< 1 \cdot 10^{-10}$ mbar.

■ CF 100 or CF 63

■ motorized

■ pressure raise in 10^{-10} mbar range

■ resolution $< 0,5^\circ$ (motorized $< 0,05^\circ$)

■ repeatability $< 0,5^\circ$ (motorized $< 0,05^\circ$)

■ optionally with optical angular encoders

www.omnivac.de

Differentially pumped rotary Feedthrough CF100/63

OmniVac offers differentially pumped rotary feedthroughs for CF 63 and CF 100 flange size.

Two pumping stages connected to a roughing and a turbo pump ensure leak rates during rotation smaller than $1 \cdot 10^{-10}$ mbar l/s.

Motorized, the resolution is better than $0,05^\circ$
and repeatability better than $0,05^\circ$.

Optionall the DPRF 100 can be equipped with optical angular encoders.

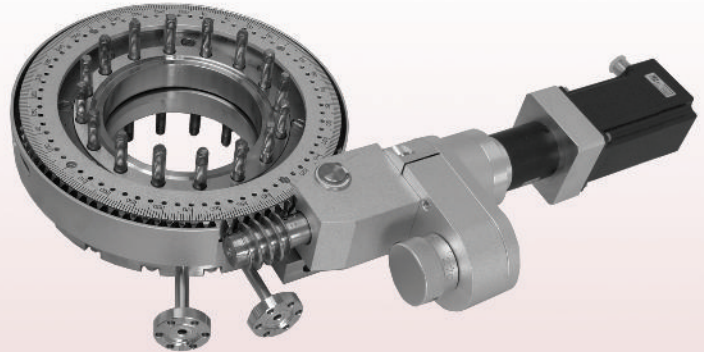

	CF 63	CF 100
mounting flange	CF 63	CF 100
rotating flange	CF 63	CF 100
open diameter	68 mm	101 mm
height	48 mm	47 mm
weight	~ 10 kg	~ 6 kg
pumping flanges	CF 16	CF 16

- use of ion pump on 2nd stage possible
- hand wheel or stepping motor driver
- fully bakeable up to 150°
- mounting and rotation flange tapped

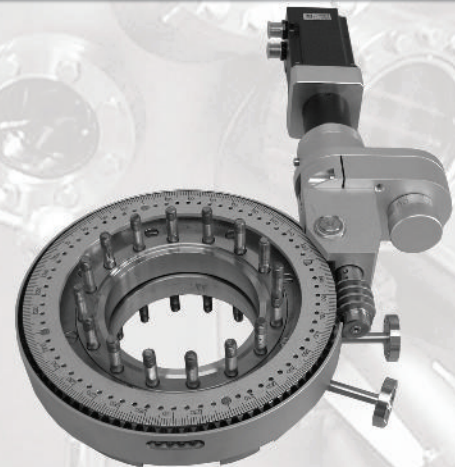

OmniVac
Hertelsbrunnenring 30
D-67657 Kaiserslautern / Germany

Tel +49 (0) 631 3110740
Fax +49 (0) 631 28056
sales@omnivac.de